

Finch Green, Chorleywood, Rickmansworth, WD3

Approximate Area = 896 sq ft / 83.2 sq m  
For identification only - Not to scale

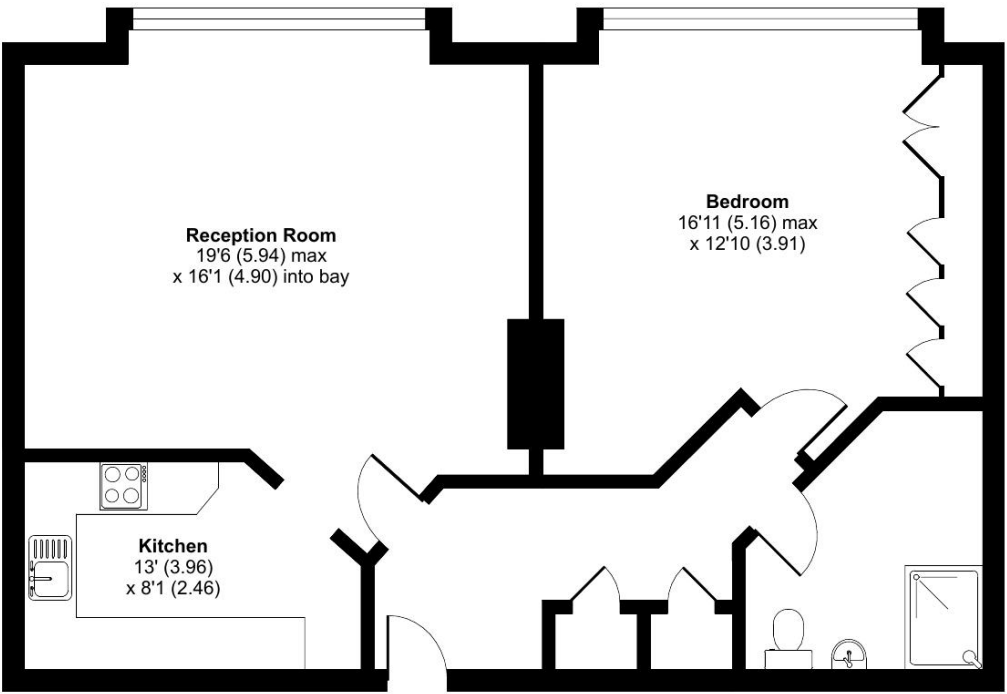

Floor plan produced in accordance with RICS Property Measurement Standards incorporating International Property Measurement Standards (IPMS2 Residential). © nchecon 2023. Produced for Retirement Villages. REF: 1037410

Talk to the team today to find out more or to arrange a visit:

01923 913 871 | CedarsVillageSales@retirementvillages.co.uk



IRC | Integrated Retirement Community



# Cedars Village

Cedars Village is a haven for walkers, golfers and wildlife enthusiasts.

RETIREMENT  
VILLAGES

## 7 The Cedars



*Situated on the first floor of the Mansion house is this beautifully presented one bedroom apartment. The property has many original features and lovely views of the croquet lawn and village grounds.*

**£435,000**  
**Leasehold\***



Apartment



1 Bedrooms



1 Bathrooms

### Key features:

- First floor apartment
- Immaculate presentation
- Character features
- EPC Rating: D



First floor conversion apartment forming part of the historic grade II listed building, renovated to a high standard by the current owner.

Living room with large sash windows, high ceilings and a feature fireplace. Modern fitted kitchen with a range of built-in appliances. Large double bedroom with feature fireplace and a range of built-in wardrobes. Fully tiled re-fitted shower room with walk-in shower.

There is a wall mounted call monitor for emergency assistance and a personal alarm necklace to alert a first responder. Lift and stairs to all floors, bus stop conveniently located outside the mansion house.

# Cedars Village is a haven for walkers, golfers and wildlife enthusiasts.

Neighbouring towns include Watford, Hemel Hempstead and High Wycombe, perfect for trips out and bustling shopping centres. With such easy travel links into London, take advantage of the many theatres, museums, concerts, shops and restaurants the city has to offer. Or head out to the Chiltern Hills for miles and miles of hiking and cycling trails, pubs and farm shops.

## Amenities and features:

- Set within 22 acres of gardens, meadows and orchards
- Grade II Listed mansion
- Conservatory
- A packed calendar of resident events
- Woodland walks and games lawn

