

Wargrave Road, Henley-on-Thames, RG9

Approximate Area = 602 sq ft / 55.9 sq m
For identification only - Not to scale

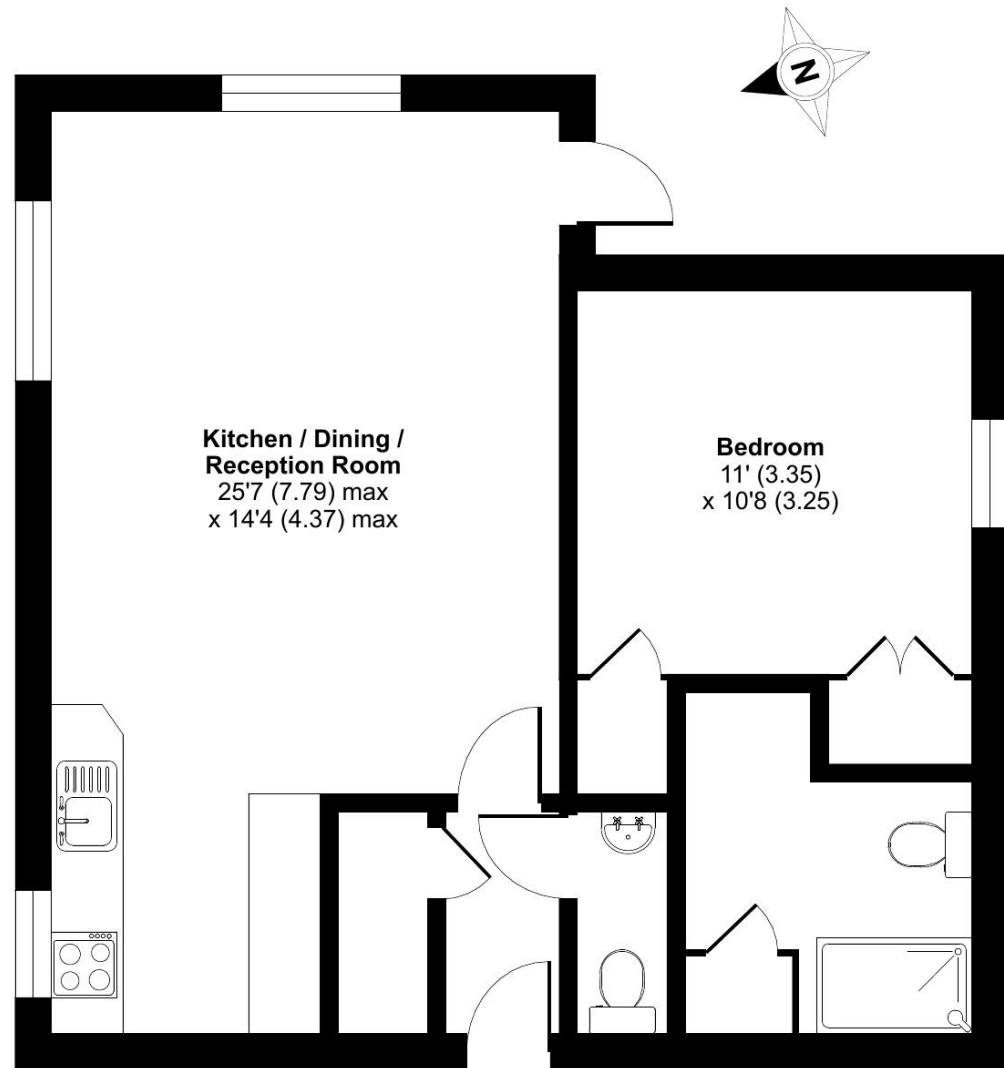

GROUND FLOOR



Floor plan produced in accordance with RICS Property Measurement Standards incorporating International Property Measurement Standards (IPMS2 Residential). © nchecon 2023. Produced for Retirement Villages. REF: 989259

Talk to the team today to find out more or to arrange a visit:

01491 736 467 | ThamesfieldVillageSales@retirementvillages.co.uk



IRC | Integrated Retirement Community



Thamesfield Village

RETIREMENT VILLAGES

Thamesfield is perfect for those looking to keep the diary full and body and mind active.

7 Ascot



Coming Soon - Recently refurbished to modern day standards this ground floor one bedroom apartment offers ease of living and elegant surroundings within a short walk of Henley's vibrant town centre

£4,250
Monthly inclusive charge



Apartment



1 Bedrooms



1 Bathrooms

Key features:

- Modern Refurb
- Ground floor to gardens
- Easy access to all amenities
- EPC Rating: D



Thamesfield is perfect for those looking to keep the diary full and body and mind active.

Located on the edge of the beautiful and historic town of Henley-Up-on-Thames. Great local facilities are just a short walk away along with lots of small, independent shops and restaurants as well as the usual high street names. Reading and Windsor are easily accessible if you need to head into a busier setting. London, with all the culture it has to offer, can be reach in under an hour from the local train station.

Amenities and features:

- Fantastic grounds and riverside location
- Converted Victorian country house
- Great transport links into London
- A packed calendar of resident events
- River facing lounge
- Pets are more than welcome!

ADDITIONAL BENEFITS WITHIN THE MONTHLY INCLUSIVE CHARGES INCLUDE SERVICE CHARGE ± MAJOR UTILITIES OF GAS/WATER ± ELECTRICITY

With both front door and garden access this one bedroom apartment will not disappoint. This recently refurbished apartment comprises hallway, WC, open plan living/dining area with picture windows to front and side that offers tranquil views and privacy. Good size double bedroom benefits from fitted wardrobe and an en suite wet room.

Thamesfield Retirement Village, nestled by Henley-on-Thames' riverbanks, features a 19th-century mansion amid three acres of lush gardens, exuding opulence. We take pride in being a small intimate community where residents partake in activities such as croquet, play readings, quizzes, films, and excursions. All our properties are conveniently accessible within the main building granting easy access to the riverfront restaurant, bar and decking area. A bridge stroll leads to Henley's historic town, and a bus outside provides access to amenities. Alternatively, an onsite restaurant is perfect for entertaining guests. Weekly services include an hour of cleaning, bed linen laundry, round-the-clock assistance, morning coffee, and afternoon tea. The village covers heating, water, and electricity costs for apartments and communal spaces, creating a convenient and luxurious retirement experience.

