

# Charters Village Drive, East Grinstead, RH19

Approximate Area = 674 sq ft / 62.6 sq m  
For identification only - Not to scale

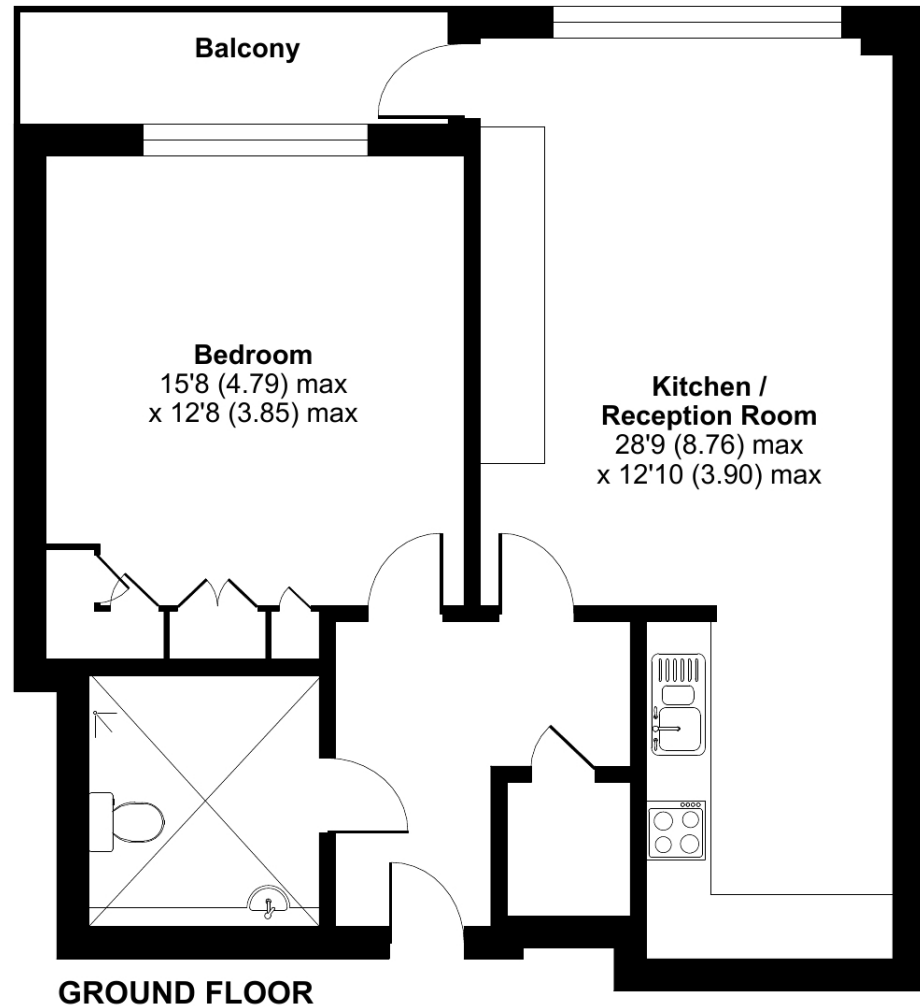

GROUND FLOOR

Floor plan produced in accordance with RICS Property Measurement 2nd Edition, Incorporating International Property Measurement Standards (IPMS2 Residential). © nchecon 2025. Produced for Retirement Security Limited. REF: 1299669

**Talk to the team today to find out more:**

01342 870 871  
ChartersVillageSales@retirementvillages.co.uk

Charters Village  
East Grinstead  
West Sussex  
RH19 2HQ



# Charters Village

RETIREMENT  
VILLAGES

*The perfect place for somebody  
who loves a full diary*



## 6 Medway House

*Introducing a well-presented one-bedroom ground floor apartment with fantastic rear pond views and a private balcony, plus newly fitted bedroom, lounge wall units and upgraded bathroom tiling.*

**£369,950**

**Other charges apply**

**Leasehold**



1 Bedrooms



1 Bathrooms



Apartment



Balcony

*Key features:*

- **Completely upgraded fittings throughout**
- **Private Balcony**
- **Underfloor Heating**
- **EPC Rating: B**



This well presented one bedroom ground floor apartment has a spacious L shaped hallway with high ceilings and coving. There is a stage cupboard housing a fuse box and door leading to the rest of accommodation. The sitting/dining room has a lovely sized room with a picture frame window with fitted curtains overlooking the village pond and communal gardens. There is a door with roller blind leading out onto a private westerly facing balcony with space for a table and chairs.

The Open plan kitchen has a modern grey eye and base level units with complementary granite effect work surfaces incorporating a one-and-a-half bowl stainless steel sink and drainer unit. The bedroom has a rear aspect picture window with fitted curtains, coved ceiling, triple built-in wardrobe with sliding doors. The wet room has a shower with glass shield and shower attachment with non-slip flooring.

Medway House is well located for access to the main clubhouse which has a restaurant, library and the village reception.

# Charters Village is perfect for those looking to keep the diary full and body and mind active.

*Packed full of amenities and features:*

- Beautiful extensive grounds based around Charters Towers
- Games lawn and pavilion
- Onsite shop
- Sunroom
- A packed calendar of events and activities

Charters Village is located close to East Grinstead, where you'll find plenty of essential amenities and facilities. If you're a fan of the great outdoors, Chartham Park is a short 10-minute walk away, a gorgeous place to play golf, visit the gym, have a bite to eat in the restaurant or simply take a stroll.

