

Charters Village, East Grinstead, RH19

Approximate Area = 1074 sq ft / 99.8 sq m  
For identification only - Not to scale

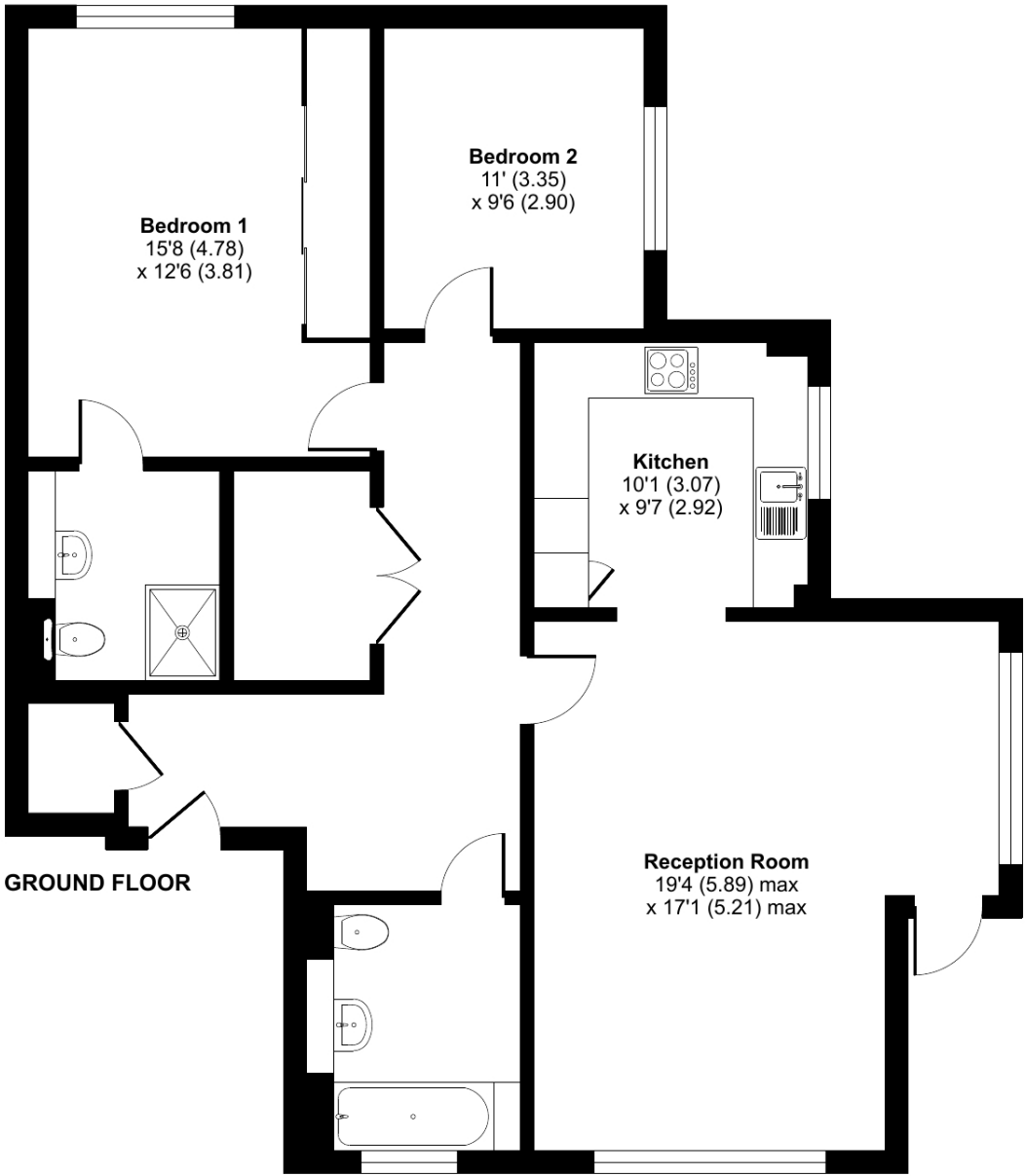

Floor plan produced in accordance with RICS Property Measurement Standards incorporating International Property Measurement Standards (IPMS2 Residential). © nichecom 2024. Produced for Retirement Villages. REF: 1095272

Talk to the team today to find out more:

01342 870 871  
ChartersVillageSales@retirementvillages.co.uk

Charters Village  
East Grinstead  
West Sussex  
RH19 2HQ



# Charters Village

RETIREMENT  
VILLAGES

*The perfect place for somebody  
who loves a full diary*



## 6 Bush Davies House

*This well-proportioned 2 bedroom ground floor apartment is ready for immediate occupation. Underfloor heating throughout, extensive storage cupboards, generously sized bathrooms and a door leading to the patio.*

**£4,250**  
**Monthly inclusive charge**



2 Bedrooms



2 Bathrooms



Apartment



Private Terrace

Key features:

- Dual aspect Lounge
- 2 Storage Cupboards
- Weekly clean
- EPC Rating: C





This well-proportioned and beautifully appointed, light and bright apartment is ready for immediate occupation. Very convenient for access, generous ceiling height, underfloor heating throughout, extensive storage cupboards, generously sized bathrooms with chrome heated towel rails and a door leading out to the patio.

Charters offers diverse apartments and cottages within a 17-acre estate, with varying sizes and views including the games lawn and bordering forest. Our residents benefit from a wide array of amenities including art and craft activities, a nature trail, community gardening, and a clubhouse with a lounge and bistro, along with a bustling social calendar. It's more than a home; Charters is a place to truly belong and thrive. Extended family, friends, and pets are welcome, with a guest suite available. This is more than just your home; it's your community, and we're here to ensure that you and your loved ones make the most of every moment spent here.

# Charters Village is perfect for those looking to keep the diary full and body and mind active.

*Packed full of amenities and features:*

- Beautiful extensive grounds based around Charters Towers
- Games lawn and pavilion
- Onsite shop
- Sunroom
- A packed calendar of events and activities

Charters Village is located close to East Grinstead, where you'll find plenty of essential amenities and facilities. If you're a fan of the great outdoors, Chartham Park is a short 10-minute walk away, a gorgeous place to play golf, visit the gym, have a bite to eat in the restaurant or simply take a stroll.

