

Jackson Close, Elmbridge Village, Cranleigh, GU6

Approximate Area = 790 sq ft / 73.3 sq m

For identification only - Not to scale

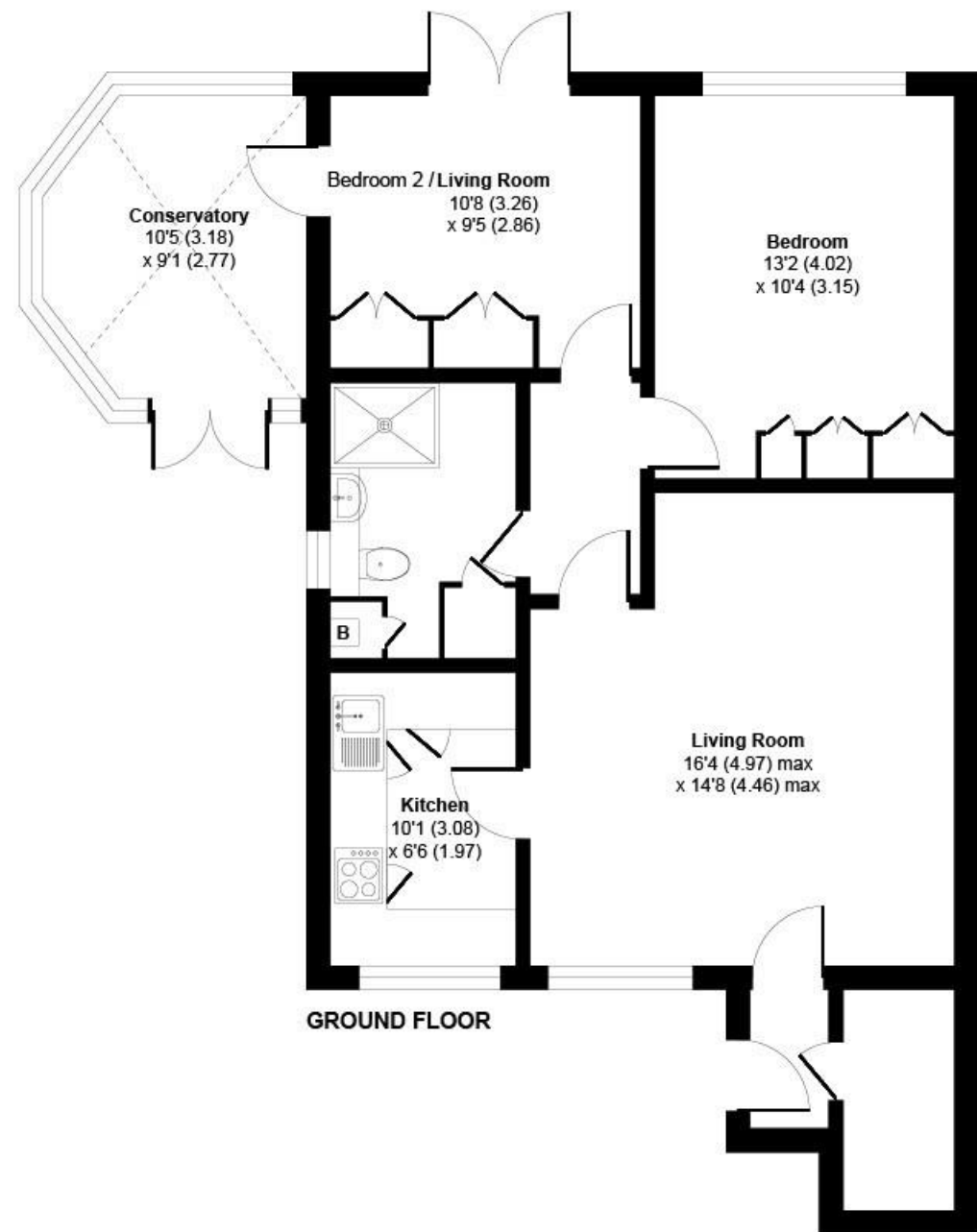

Floor plan produced in accordance with RICS Property Measurement 2nd Edition, incorporating International Property Measurement Standards (IPMS2 Residential). © richacom 2025. Produced for Retirement Security Limited. REF: 1332467

Talk to the team today to find out more:

01483 672 629
ElmbridgeVillageSales@retirementvillages.co.uk

Elmbridge Village
Cranleigh
Surrey
GU6 8TR

Elmbridge Village

RETIREMENT
VILLAGES

*Friendly and Engaging with
Amenities to suit all..*



4 Jackson Close

With a conservatory and views to the gardens this ground floor apartment offers flexible and spacious living

£390,000

Other charges apply

Leasehold



2 Bedrooms



1 Bathrooms



Apartment



Conservatory

Key features:

- Secluded location
- Garden views
- Two bedrooms
- EPC Rating: C





Within the gardens of Jackson Close this delightful two bedroom ground floor property has a conservatory offering views to the gardens. Spacious living/dining room with a glazed door to a fully fitted kitchen with cream units and complementary worktops. Integrated electric oven and hob, space for a washer dryer and fridge freezer. Main bedroom with views to the gardens. Second bedroom with French doors to a patio and door to the conservatory. From here there is a further French door leading to an additional patio and the gardens beyond.

Elmbridge is a well-established village with 276 homes, including bungalows and apartments, set within in 27 acres of landscaped grounds. Located near the charming Cranleigh village, Elmbridge offers residents a range of amenities such as a restaurant, a lively bar, village hall, hair salon, croquet lawn, on-site store, library, and regular doctor's surgeries. Those with green fingers can enjoy our lively allotments, and there's a beautiful walking meadow and daily bus service for a well-rounded lifestyle.

Elmbridge Village is a thriving community where you can join in everything, or just simply sit back and relax.

Packed full of amenities and features:

- Nature walk and allotments
- On site restaurant, bar and lounge
- A village shop
- Wellness centre
- Hair salon
- A packed calendar of resident events

Elmbridge Village is just outside Cranleigh, eight miles southeast of Guildford. It has a vibrant high street made up of independent shops, cafés, restaurants and typical amenities such as supermarkets, leisure and health centres. From festivals and arts to the Cranleigh Bowls Club and the Cranleigh Cricket Academy, there is plenty going on year round.

