

Essex Drive, Cranleigh, GU6

Approximate Area = 784 sq ft / 72.8 sq m

For identification only - Not to scale

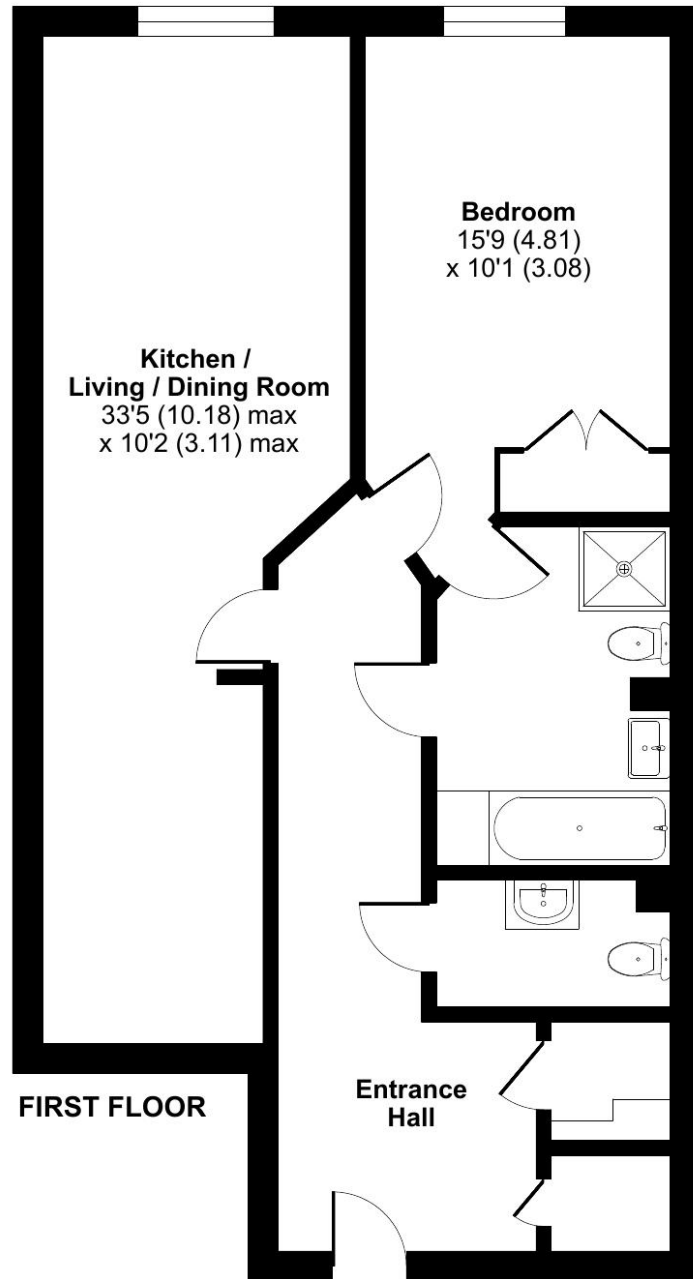

Floor plan produced in accordance with RICS Property Measurement 2nd Edition, Incorporating International Property Measurement Standards (IPMS2 Residential). © nichecom 2026. Produced for RV Services Limited (Retirement Villages). REF: 1418665

Talk to the team today to find out more or to arrange a visit:

01483 672 629 | ElmbridgeVillageSales@retirementvillages.co.uk



© IRC | Integrated Retirement Community



Elmbridge Village

RETIREMENT VILLAGES

Elmbridge Village is a thriving community where you can join in everything, or simply relax.

3 Elmbridge Manor



Spacious one-bedroom apartment provides a welcoming and secure home in a friendly retirement community.



Apartment



1 Bedroom



1 Bathroom

Key features:

- Spacious one-bedroom apartment
- Newly redecorated
- Fully fitted kitchen
- EPC Rating: B

£385,000

Leasehold*



Elmbridge Village is a thriving community where you can join in everything, or simply relax.

Elmbridge is just outside Cranleigh, eight miles southeast of Guilford. It has a vibrant high street made up of independent shops, cafes, restaurants and typical amenities such as supermarkets, leisure and health centres. From festivals and arts to the Cranleigh Bowls Club and the Cranleigh Cricket Academy, there is plenty going on year round.

Amenities and features:

- Nature walk and allotments
- On site restaurant, bar and lounge
- A village shop
- Wellness centre
- Hair salon
- A packed calendar of events

This spacious one-bedroom apartment offers comfort, convenience, and peace of mind in the heart of our retirement village. Located in Elmbridge Manor, with lift access to the facilities, it is perfectly designed for easy, independent living.

Newly decorated and carpeted throughout, the apartment features a modern kitchen with contemporary units and integrated appliances, including a dishwasher, fridge freezer, eye-level oven, and electric hob.

The bright double bedroom includes built-in storage, while the en suite bathroom offers a stylish walk-in shower for ease of access, complemented by a separate WC for added convenience. Thoughtful storage solutions are provided throughout the apartment, including a utility cupboard with plumbing for a washing machine.

