

## Elmbridge Village, GU6

Approximate Area = 663 sq ft / 61.6 sq m

For identification only - Not to scale

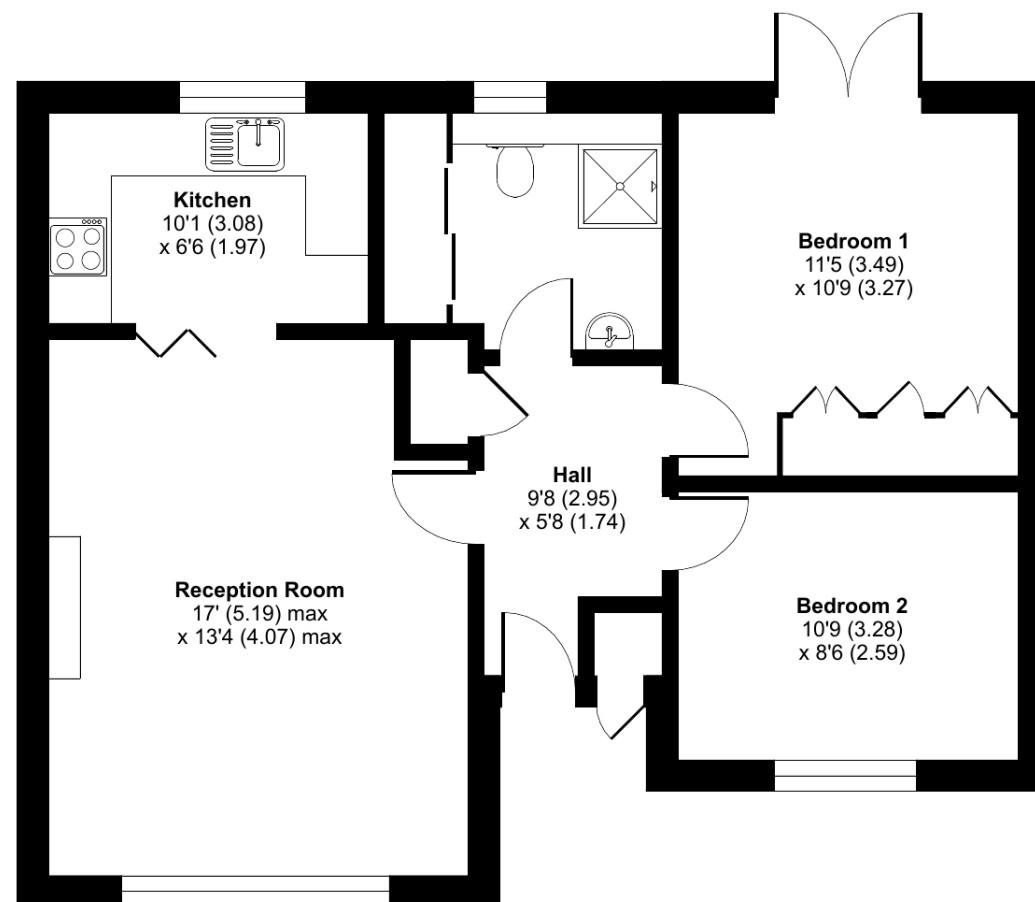

GROUND FLOOR

Floor plan produced in accordance with RICS Property Measurement 2nd Edition, Incorporating International Property Measurement Standards (IPMS2 Residential). © n/checom 2025. Produced for Retirement Security Limited. REF: 1261517

**Talk to the team today to find out more:**

01483 672 629

[ElmbridgeVillageSales@retirementvillages.co.uk](mailto:ElmbridgeVillageSales@retirementvillages.co.uk)

Elmbridge Village  
Cranleigh  
Surrey  
GU6 8TR



# Elmbridge Village

RETIREMENT  
VILLAGES

*Friendly and Engaging with  
Amenities to suit all..*



## 18 Day Court

*A two bedroom bungalow  
overlooking the croquet lawn and  
Manor House, located in a sought  
after location within the village.*

**£370,000**

**Other charges apply**

**Leasehold**



2 Bedrooms



1 Bathrooms



Bungalow

*Key features:*

- **Popular location overlooking the croquet lawn**
- **Two bedrooms**
- **Excellent facilities**





With French doors opening to the patio this bungalow is in a prime location within Elmbridge Village overlooking the croquet lawn. A spacious sitting/dining room with large picture windows offers views across the communal gardens of Day Court. A modern fitted pine effect kitchen with granite effect worktops featuring an integrated dishwasher and includes space for an electric oven and fridge freezer.

Double bedroom with a range of fitted cupboards and a door to the patio overlooking the croquet lawn. Second bedroom with views to Day Court. Bathroom with shower cubicle, cupboard with plumbing for a washing machine and space for a tumble dryer.

Elmbridge is a well-established village with 276 homes, including bungalows and apartments, set within in 27 acres of landscaped grounds. Located near the charming Cranleigh village, Elmbridge offers residents a range of amenities such as a restaurant, a lively bar, village hall, hair salon, croquet lawn, on-site store, library, and regular doctor's surgeries. Those with green fingers can enjoy our lively allotments, and there's a beautiful walking meadow and daily bus service for a well-rounded lifestyle.

# Elmbridge Village is a thriving community where you can join in everything, or just simply sit back and relax.

*Packed full of amenities and features:*

- Nature walk and allotments
- On site restaurant, bar and lounge
- A village shop
- Wellness centre
- Hair salon
- A packed calendar of resident events

Elmbridge Village is just outside Cranleigh, eight miles southeast of Guildford. It has a vibrant high street made up of independent shops, cafés, restaurants and typical amenities such as supermarkets, leisure and health centres. From festivals and arts to the Cranleigh Bowls Club and the Cranleigh Cricket Academy, there is plenty going on year round.

