

Woodland Place, Castle Village, Chorleywood

Approximate Area = 757 sq ft / 70.3 sq m

For identification only - Not to scale

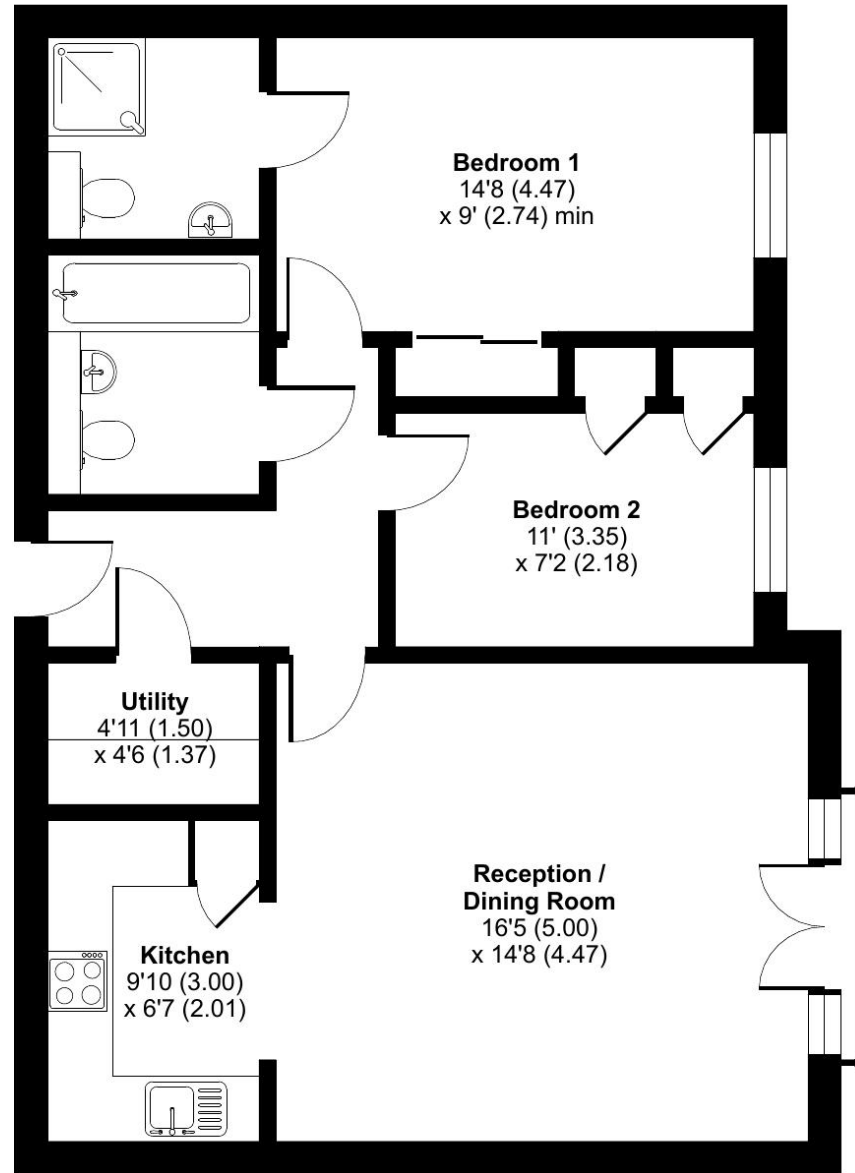

FIRST FLOOR

Talk to the team today to find out more or to arrange a visit:

01923 913 871 | CedarsVillageSales@retirementvillages.co.uk



IRC | Integrated Retirement Community



Cedars Village

Cedars Village is a haven for walkers, golfers and wildlife enthusiasts.

RETIREMENT
VILLAGES

17 WOODLAND PLACE



An immaculately presented, newly refurbished two bedroom first floor apartment with woodland views. Benefiting from a fully fitted kitchen, Utility Room and En Suite in the Master Bedroom.



Apartment



2 Bedrooms



2 Bathrooms

Key features:

- Newly Refurbished Apartment
- Juliette balcony overlooking woodland
- Fully fitted kitchen
- EPC Rating: C

£3,250

Monthly inclusive charge

Cedars Village is a haven for walkers, golfers and wildlife enthusiasts.

Neighbouring towns include Watford, Hemel Hempstead and High Wycombe, perfect for trips out and bustling shopping centres. With such easy travel links into London, take advantage of the many theatres, museums, concerts, shops and restaurants the city has to offer. Or head out to the Chiltern Hills for miles and miles of hiking and cycling trails, pubs and farm shops.

Amenities and features:

- Set within 22 acres of gardens, meadows and orchards
- Grade II Listed mansion
- Conservatory
- A packed calendar of resident events
- Woodland walks and games lawn

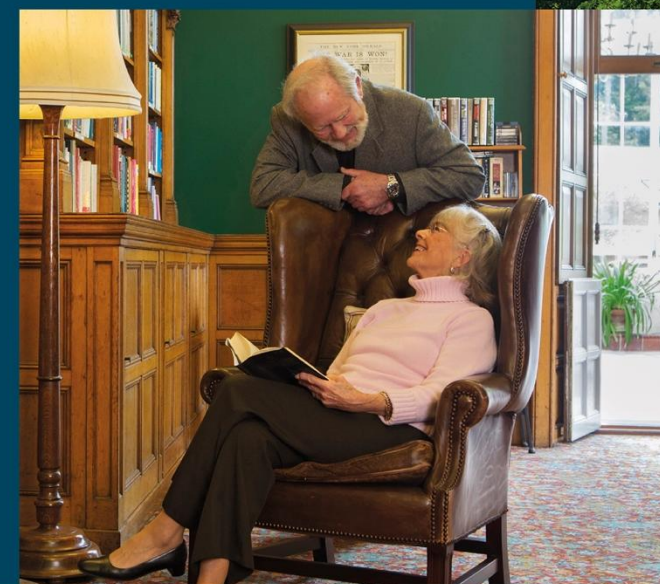

A modern and renovated, two bedroom apartment in Woodland Place. Entrance hallway with utility cupboard housing a freestanding Beko washer/dryer, bathroom with bath and shower attachment, door leading to spacious living room with a Juliette balcony overlooking woodland, fully fitted kitchen with brand new integrated Lamona appliances including a dishwasher, fridge/freezer, induction hob. Built-in eye level Neff oven. Master bedroom with en-suite shower room, built-in double wardrobe, second bedroom with built-in cupboard and a cupboard housing a Glow-Worm Combi-Boiler. There is a wall mounted call monitor for emergency assistance and a personal alarm necklace to alert a first responder.

Cedars Village sits in an idyllic spot set opposite the common, away from the main road amidst 22 acres of landscaped gardens. Built around the exclusive Grade II listed mansion house with its Victorian conservatory it boasts an unrivalled ambience. Newly refurbished to a high standard, facilities include bistro-bar, library, restaurant, convenience store and croquet/putting lawn. Opening soon are the year-round conservatory, hair salon, health centre and activities room. Cedars Village provides comfort and security where community and lifestyle are of paramount importance.